

For further assistance, please
visit [Tenovi.com/support](https://tenovi.com/support).

tenovi

© 2025 Tenovi Co.
All rights reserved. Republication, duplication or modification
in whole or in part is prohibited without prior written permission
from Tenovi. All trademarks are owned by or licensed to
Tenovi, Co. unless otherwise noted.
Revision 05.01.2024

Power Your Gateway

1

Plug your Gateway into a power outlet with the provided power cord and wait until the LED on the Gateway turns **RED**.



Attach to inhaler

2

Open the cover by pulling the clips. Place the inhaler into the sensor with the dose counter facing upwards. Close the sensor ensuring the clips snap on both sides.

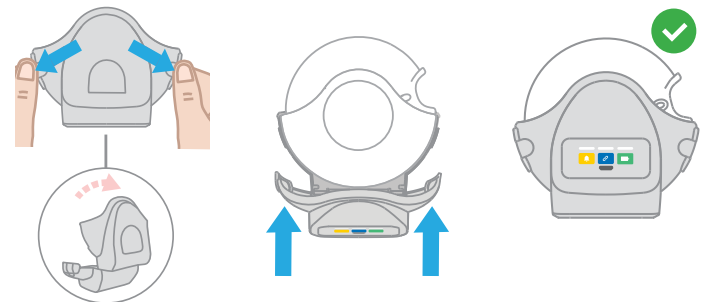

3

Bond to Gateway

Press the button with the chain icon three times fairly quickly. The light on the sensor will flash blue a few times then green to signal it's paired.



5

Daily Measurements

When the measurement concludes, the Gateway will beep and the LED ring will turn green, indicating that you have properly taken a measurement, and that measurement was successfully transmitted.



4

Delivering Medication

Refer to the labelling provided with the inhaler for instructions on use. Carry out all steps required to use your inhaler according to the instructions.



adherium

6

Take a measurement

Press the power button to take a measurement. Wait for the screen to turn off before removing the cuff. If the LED ring is green, you have properly taken a measurement for the day, and that measurement has been successfully transmitted.

