



For more information about your device, use your phone to scan the QR code below or visit our support site at tenovi.com/12



© 2025 Tenovi Co.
All rights reserved. Republication, duplication or modification in whole or in part is prohibited without prior written permission from Tenovi. All trademarks are owned by or licensed to Tenovi, Co. unless otherwise noted.
Revision 11.17.25

Power Your Gateway

1

Plug your Gateway into a power outlet with the provided power cord and wait until the LED on the Gateway turns **RED**.



Insert Batteries

2

Insert batteries into the back of the Peak Flow Meter.

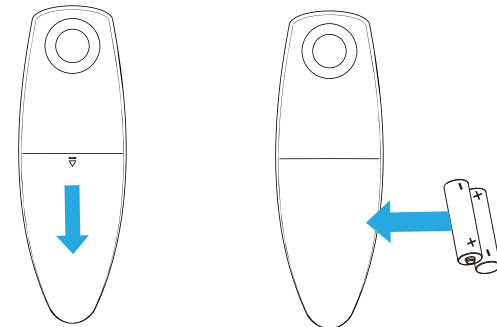

Connect To Gateway

3

Stand within 20 feet of the Tenovi Gateway, press the **power button** for 3 seconds and wait for the Tenovi Gateway to start flashing yellow.



Displaying Measurement

5

Your measurement will be displayed on the Peak Flow Meter screen and the Gateway LED should turn **green**. Press the **power button** and start at Step 3 if you need to take another reading.

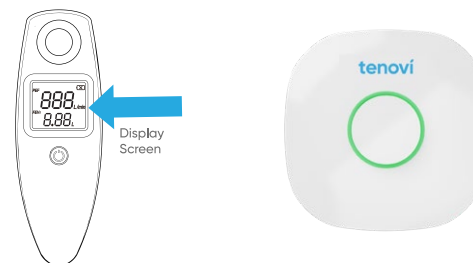

Take A Measurement

4

Take a deep breath

Place the mouthpiece in your mouth and **seal your lips tightly around it**. Blow out as **hard and fast** as you can in one breath.



Daily Measurements

6

Take one measurement each day unless advised by your healthcare provider. The LED light will turn **RED** at midnight then turn **GREEN** and BEEP once your first measurement for the day has been successfully transmitted. **You can continue to take additional measurements and they will be transmitted to the Gateway, but the color will not change.**

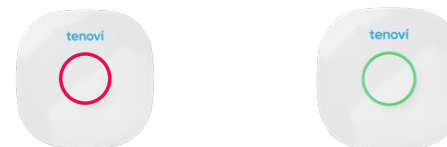

Measurement Needed

Measurement Successful