



For more information about your device, use your phone to scan the QR code below or visit our support site at tenovi.com/10

tenovi

© 2025 Tenovi Co.
All rights reserved. Republication, duplication or modification in whole or in part is prohibited without prior written permission from Tenovi. All trademarks are owned by or licensed to Tenovi, Co. unless otherwise noted.
Revision 11.17.25

1

Power Your Gateway

Plug your Gateway into a power outlet with the provided power cord and wait until the LED on the Gateway turns **RED**.



2

Insert Batteries

Insert **batteries** into the back of the glucometer. **Stand within 10 feet** of the gateway and **press the top button** on the glucometer. The gateway will beep indicating that it has connected successfully to the glucometer.

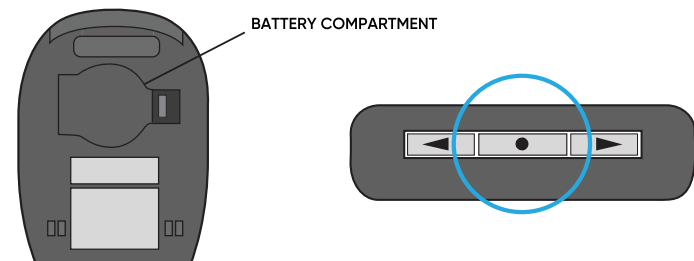

Preparation

3

Insert a test strip with the contact bars facing upwards into the meter's test strip port. **Insert a new disposable lancet firmly into the lancet holder.**

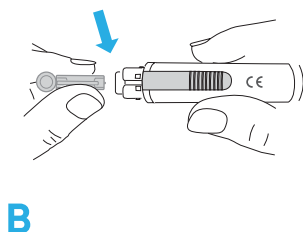
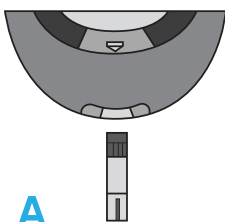

Transmit Readings

5

Remove the test strip and the screen will turn off. Stand **within 10 feet** of the gateway and **press the power button** on top of the glucometer to transmit the reading to the Gateway. You can take readings while away from the Gateway. **Press this button** the next time you are close to your Gateway to transmit all of your readings.

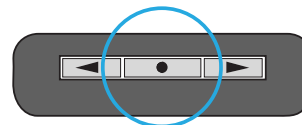

Take A Sample

4

Use prepped lancet to take a blood sample. Quickly apply the blood sample to the end of the test strip. When the measurement concludes, the results are shown on the display.

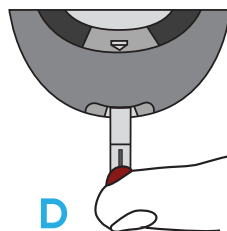
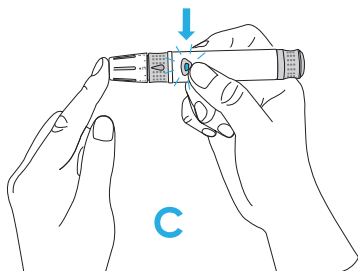

Daily Measurements

6

Take one measurement each day unless advised by your healthcare provider. The LED light will turn **RED** at midnight then turn **GREEN** and BEEP once your first measurement for the day has been successfully transmitted. **You can continue to take additional measurements and they will be transmitted to the Gateway, but the color will not change.**



Measurement Needed



Measurement Successful