

XK300 Essence User Manual

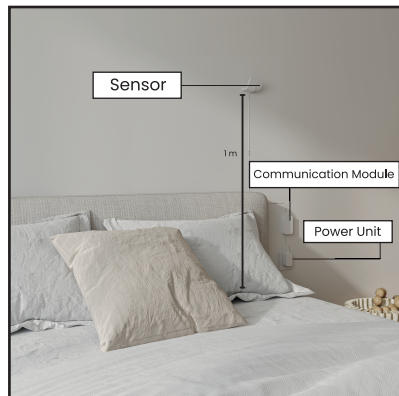

Power Your Gateway

Plug your Gateway into a power outlet with the provided power cord and wait until the LED on the Gateway turns **RED**.



Step 1 - 1.0 Sensor Mounting

Using a measuring tape, mark 1 meter above

- If you're sharing the bed, place the sensor near the edge on your side
- If you're using a single bed, place the sensor at the center of the bed.

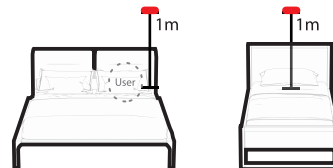

Step 2

Place the sensor on the marked spot. Insert a screwdriver through the screw hole on the sensor and lightly mark the wall.

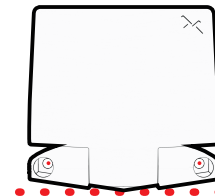

Step 3

Press the anchor tip into the wall at the marked location.

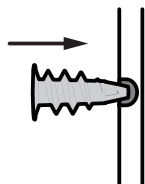

Step 4

Insert the anchor.

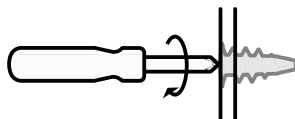

Step 5

Place the sensor back over the anchor.

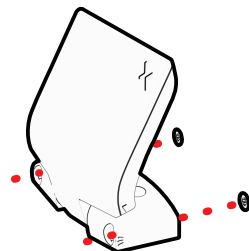

Step 6

Insert the screws in both holes.

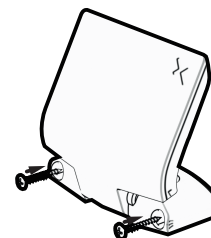

Step 7

Secure the screw inside the holes.

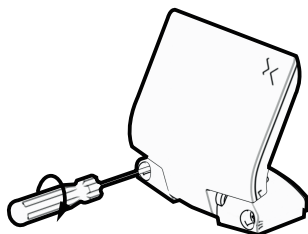

Step 8

Adjust the front side of the sensor to a 45-degree angle, pointing toward the bed.

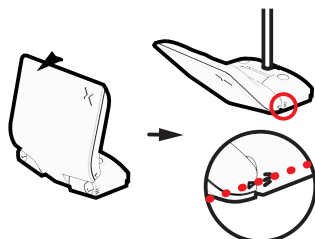

2.0 Communication Module Mounting

The Communication Module could be either positioned on the floor or a side table or mounted on the wall.

For optimal installation, it is recommended to place the module near a power outlet to facilitate easier wire connections.



2.1 Side Table Placement

For secure positioning, the provided mounting tape could be used. This is an optional accessory and may be used at the user's discretion.

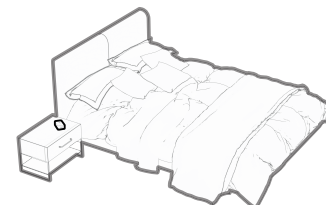

XK300 Essence User Manual

2.2 Floor Placement

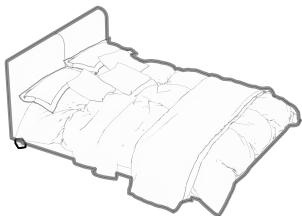

Step 1- 2.3 Wall Mounting

Mark the semi-circular spot with a pen.

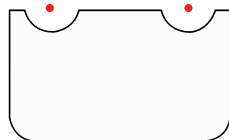

Step 2

Press the anchor tip into the wall at the marked location. Secure the anchor into the wall.

Note: For thicker or harder wall materials, pre-drill the hole.

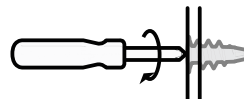

Step 3

Secure the screw inside the anchor. Leave the secondary flange of the screw exposed to allow the module to be hung.

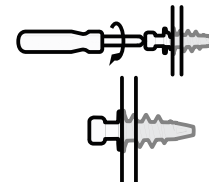

Step 4

Peel off one side of the tape.

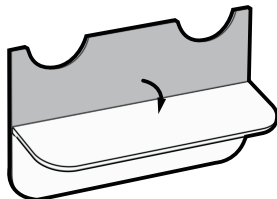

Step 5

Paste the tape according to the screw location. Then peel off the other side of the tape.

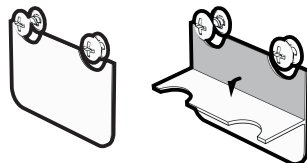

Step 6

Hang the module on the screw and press the module against the tape.

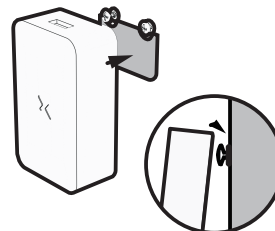

3.0 Operation Check

Connect the power to the communication module. The green LED will turn on for approximately 3 seconds, indicating that the device is receiving power.

- If the green LED does not turn on, please check the power connection.
- If the green LED turns off after 3 seconds, this indicates normal operation.

LED Status

- If the LED turns red or yellow after 3 seconds, this indicates that a fault or error has occurred. In this case, follow the steps below:

> Disconnect and reconnect the power, and check the LED status again.

> If the issue persists, please contact your place of purchase for further assistance.

4.0 Reset Button

Use the supplied reset pin to press the reset button through the RESET hole.

- Reboot: Short press to reboot the device.
- Factory reset: Press and hold (≈ 5 s) to perform a factory reset.

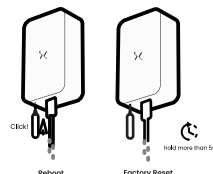

5.0 Assembly

Using the provided cables, first connect the sensor to the communication module. Then, connect the communication module to the power unit.

