

7 Take a measurement daily

Take one measurement per day unless otherwise advised by your healthcare provider. The LED on Tenovi devices will turn red at the beginning of each day reminding you to take a measurement and will turn green after the measurement has been successfully sent to your healthcare provider.



Measurement Needed



Measurement Successful

For further assistance on how to use your Tenovi device, please contact a Tenovi representative

Email: support@tenovi.com



© 2024 Tenovi Co.

All rights reserved. Reproduction, duplication or modification in whole or in part is prohibited without prior written permission from Tenovi. All trademarks are owned by or licensed to Tenovi, Co. unless otherwise noted.

Revision 05.01.2024

1 Power your Gateway

Plug your gateway into a power outlet with the provided power cord and wait until the LED on the gateway turns red.

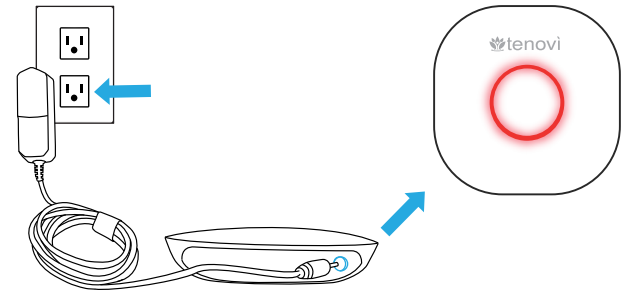

2 Remove battery cover

Remove the battery cover on the back of the scale, and insert the 4 AAA batteries.

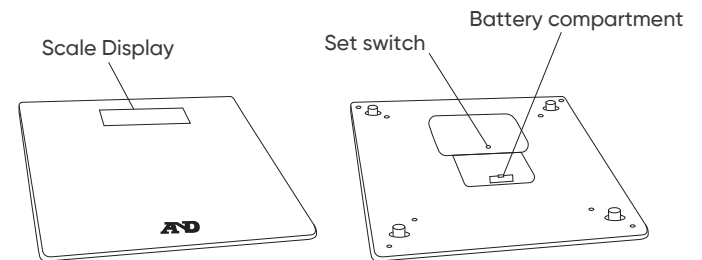

3

Pairing your Scale & Gateway

To pair your device with the Gateway, **press and hold down the "SET" button** on the back until "Pr" is displayed. After a few seconds, the gateway should flash **yellow** and beep. The scale will display "Set" when complete and is now ready for use. This pairing process only needs to be done one time.

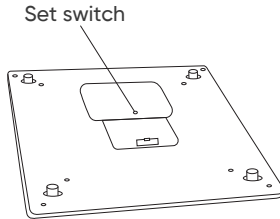

5

Properly set up

Step on the scale and remain standing until the screen displays **"step Off."** Your weight will be displayed once you step off the scale.

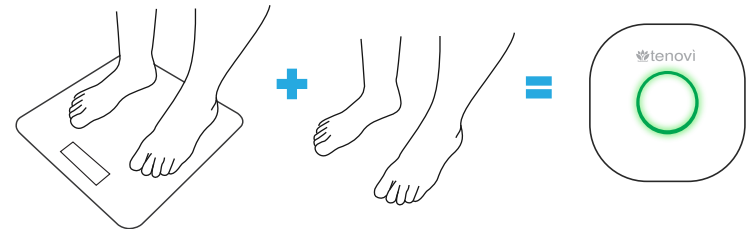

4

Scale Placement

Place the scale on a hard, even surface.
Avoid using the device on carpet.

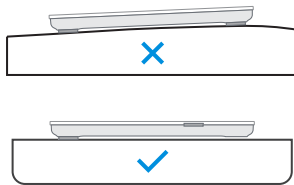

- A) Place your scale on a flat and hard surface.
- B) Do NOT place the scale on carpet or soft surface.

6

Take a measurement

When the measurement concludes, the Gateway will beep and the LED ring will turn **green**, indicating that you have properly taken a measurement, and that measurement was successfully transmitted.

